

598

THERMACORE[®] DOOR SYSTEMS



LIGHT DUTY INSULATED STEEL SECTIONAL DOORS



THERMAL PROTECTION.
STRONG AND LIGHTWEIGHT.
ENHANCED VERSATILITY.



INDUSTRY LEADING
COMMERCIAL & INDUSTRIAL SOLUTIONS



Standard features at a glance

Thermal efficiency

R-value*	9.31 (1.64 K m ² /W)
U-value	.107 (.608 W/K m ²)
Thermal break	Hot melt

Construction

Panel thickness	1" (25.4 mm)
Max height	14'1" (4293 mm)
Max width	16'2" (4928 mm)
Exterior steel	.012" (.30 mm) galvanized
Exterior surface	Ribbed, textured
Standard springs	10,000 cycle

Color options

Interior colors	White
Exterior colors	White

Limited warranty

8-year delamination
1-year door
3-year/20,000 cycle door and operator system (material and workmanship)

Options

- Thermal glazing
- High cycle springs
- Wind load options
- Electric operator
- Chain hoist
- Posi-Tension™ drums
- Safety bottom fixtures
- Flexible jamb, header seal

For drawings and specifications please visit our website, overhaddoor.com/architects-corner

* R-value is a measure of thermal efficiency. The higher the R-value the greater the insulating properties of the door. Overhead Door Corporation uses a calculated door section R-value for our insulated doors.



An economical choice for lighter-duty applications where thermal protection is important

Thermacore® Model 598 is an exceptionally well-built door that provides a higher level of thermal protection than standard insulated doors. The Thermacore® CFC-free, fully encapsulated, foamed-in place panel maintains R-value performance year round. Fabricated using our proprietary, computer-controlled manufacturing process, Model 598 adheres to strict product tolerances and quality standards – making it a solid choice for projects where economy and energy efficiency are equally important.

Panel options

Ribbed, textured panel

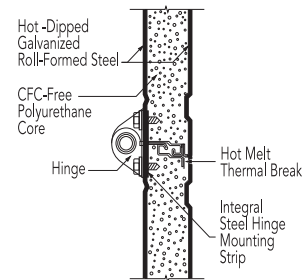
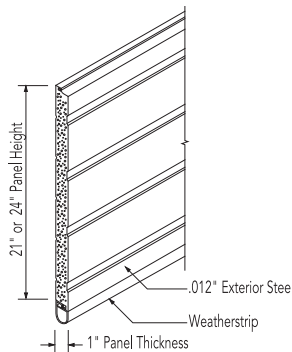
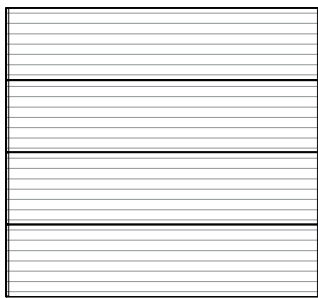

The Thermacore® steel-polyurethane-steel sandwich panel construction is lightweight, incredibly strong and exceptionally efficient – reflecting a premium level of thermal performance.

Color options

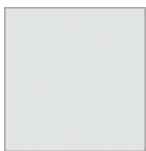

White

Actual door colors may vary from the brochure due to fluctuations in the printing process. Always request a color sample from your Overhead Door™ Distributor for accurate color matching.

Glazing options



Double Thermal Acrylic
(25" w by 12" h)



Clear Long** (44" w by 15" h)
Not available on doors wider than 20'2"



Insulated DSB
(24" w by 7" h)



Architect's Corner

A resource for architects, containing comprehensive technical and resource materials to support your project, including drawings and specifications for commercial doors.

overheaddoor.com

The original, innovative choice for unequalled quality and service.

Overhead Door Corporation pioneered the upward-acting door industry, inventing the first upward-acting door in 1921 and the first electric door operator in 1926. Today, we continue to be the industry leader through the strength of our product innovation, superior craftsmanship and outstanding customer support, underscoring a legacy of quality, expertise and integrity. That's why design and construction professionals specify Overhead Door™ products more often than any other brand. Our family of over 400 Overhead Door™ Distributors across the U.S. and Canada not only share our name and logo, but also our commitment to excellence.



INDUSTRY LEADING
COMMERCIAL & INDUSTRIAL SOLUTIONS

 Fray Pedro de Gante 85, Cimatario, Santiago de Querétaro, Querétaro, México CP 76030

 (442) 727-0441

 contacto@klh.com.mx

klh de México
www.klh.com.mx